

MODEL DHP 65 DV

UNIT 1

ILLUSTRATED PARTS BREAKDOWN

Rev. - - Jan. 2015

www.serviscentrum.cz
+420 607 607 077
info@serviscentrum.cz

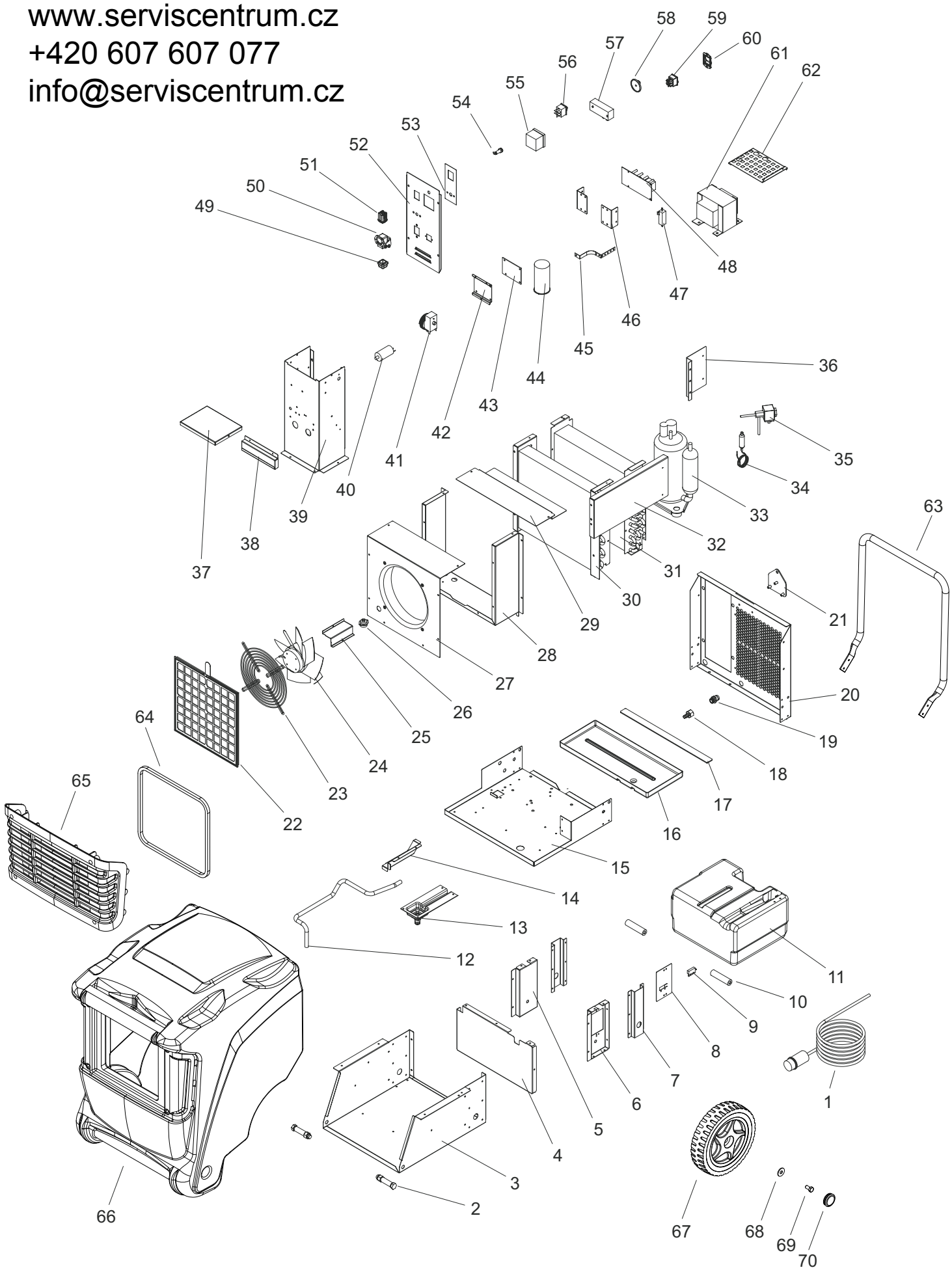

| Pos. | Code NR | Description |
|------|----------|------------------------------|
| 1 | 4140.487 | POWER CORD 115V |
| 2 | 4140.482 | KIT PIVOT ROTATION |
| 3 | 4140.432 | BOTTOM |
| 4 | 4140.435 | VERTICAL PANEL |
| 5 | 4140.434 | RIGHT WHEEL BRACKET |
| 6 | 4140.455 | LEFT WHEEL BRACKET |
| 7 | 4140.459 | WHEEL REINFORCE |
| 8 | 4140.448 | SENSOR SUPPORT |
| 9 | 4140.430 | FLOATING SENSOR |
| 10 | 4140.452 | AXIAL PIPE |
| 11 | 4140.481 | TANK COMPLETE |
| 12 | 4140.476 | RUBBER PIPE 8x12 |
| 13 | 4140.485 | DRAINAGE CANAL |
| 14 | 4140.451 | DUCT CABLES |
| 15 | 4140.433 | FIRST FLOOR |
| 16 | 4140.443 | EVAPORATOR TRAY |
| 17 | 4140.461 | RISE FOR TRAY |
| 18 | 4140.484 | HOSE HOLDER Ø10 |
| 19 | 4140.478 | HOSE HOLDER Ø16 |
| 20 | 4140.436 | BACK PANEL |
| 21 | 4140.450 | COVER FLANGE |
| 22 | 4140.486 | AIR FILTER |
| 23 | 4140.466 | FAN GRILLE |
| 24 | 4140.467 | FAN Ø200 |
| 25 | 4140.453 | PROTECTION PUMP CONNECTION |
| 26 | 4140.473 | SOCKET 6 PIN |
| 27 | 4140.440 | FAN CONVEYOR |
| 28 | 4140.439 | PLENUM FAN CONVEYOR |
| 29 | 4140.464 | TOP COILS |
| 30 | 4140.462 | EVAPORATOR |
| 31 | 4140.463 | CONDENSER |
| 32 | 4140.449 | COILS PROTECTION |
| 33 | 4140.428 | COMPRESSOR |
| 34 | 4140.488 | REFRIGERANT FILTER+CAPILLARY |
| 35 | 4140.426 | ELECTROVALVE WITH COIL |
| 36 | 4140.456 | COILS SUPPORT |
| 37 | 4140.438 | TOP ELECTRICAL BOX |
| 38 | 4140.454 | PROTECTION OUTPUT CABLES |
| 39 | 4140.437 | ELECTRICAL BOX |

| Pos. | Code NR | Description |
|------|----------|--------------------------------|
| 40 | 4140.468 | FAN CAPACITOR |
| 41 | 4140.180 | THERMOSTAT |
| 42 | 4140.446 | PCB FLOAT SUPPORT |
| 43 | 4140.477 | PCB FLOAT |
| 44 | 4140.489 | COMPRESSOR CAPACITOR |
| 45 | 4140.431 | CAPACITOR BELT |
| 46 | 4140.445 | PCB SUPPORT |
| 47 | 4140.465 | RESISTANCE ADJUSTAMENT SPEED |
| 48 | 4140.162 | PCB MACHINE |
| 49 | 4140.475 | CAP CONNECTION 90° |
| 50 | 4140.469 | CONNECTION 90° |
| 51 | 4140.472 | SOCKET FOR CONNECTION 90° |
| 52 | 4140.444 | ELECTRIC BOX DOOR |
| 53 | 4140.457 | LABEL |
| 54 | 4140.474 | RED LED |
| 55 | 4140.158 | HOUR COUNTER |
| 56 | 4140.429 | SWITCH FAN SPEED |
| 57 | 4140.245 | DEHUMIDISTAT |
| 58 | 4140.204 | KNOB |
| 59 | 4140.470 | SWITCH DUAL VOLTAGE |
| 60 | 4140.471 | PROTECTION SWITCH DUAL VOLTAGE |
| 61 | 4140.483 | AUTOTRANSFORMER |
| 62 | 4140.460 | WIRING PROTECTION |
| 63 | 4140.036 | HANDLE |
| 64 | 4140.104 | GASKET |
| 65 | 4140.068 | FILTER COVER |
| 66 | 4140.067 | PLASTIC COVER (YELLOW) |
| 67 | 4032.094 | WHEEL |
| 68 | 4140.078 | WASHER |
| 69 | 4140.094 | SCREW |
| 70 | 4111.480 | WHEEL COVER |