

Model: DH 721

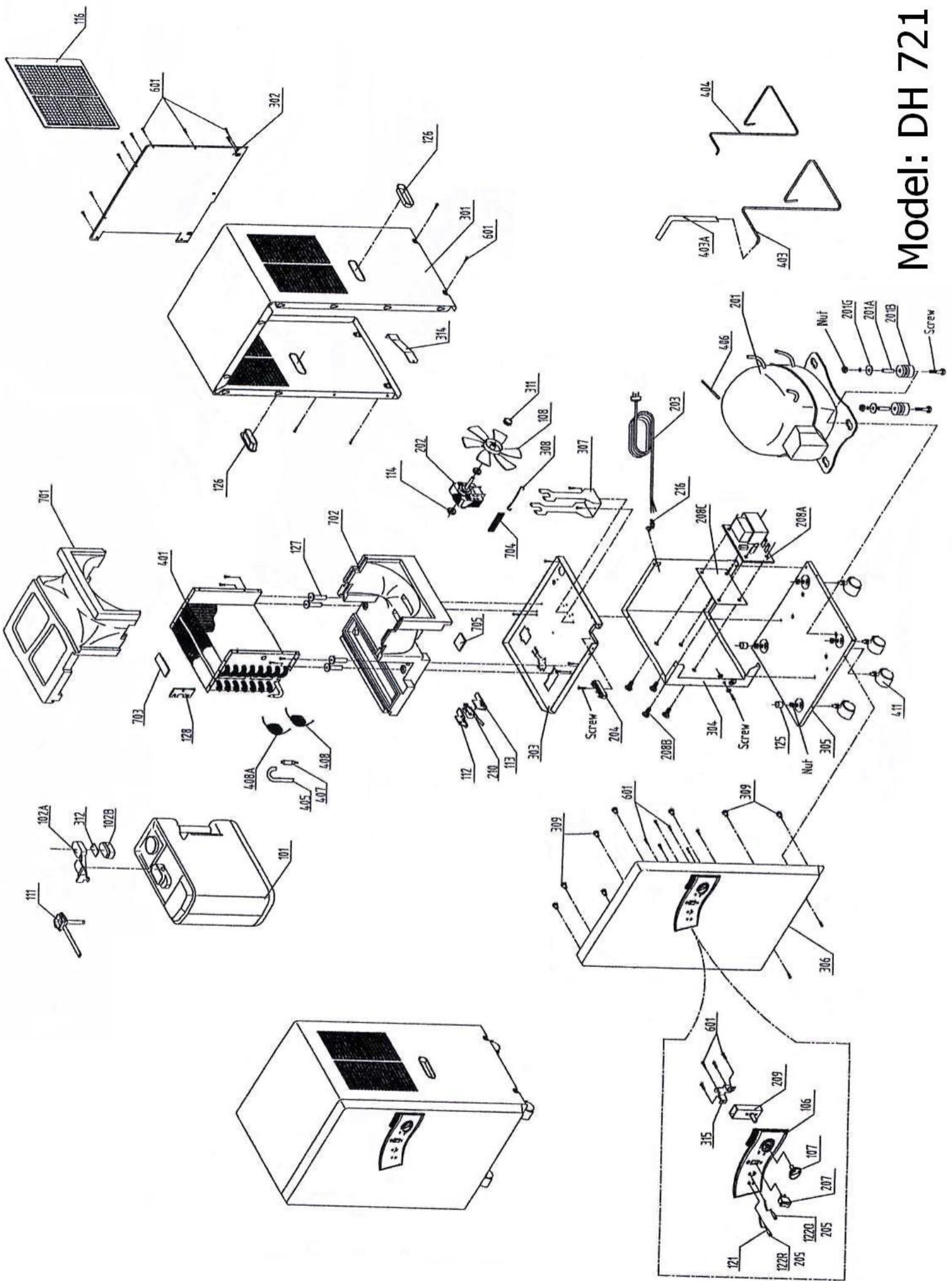

Key no.	Part no.	Description	q'ty	Key no.	Part no.	Description	q'ty
101	4512.300	Water Tank	1	302	4512.337	Rear Plate	1
102A	4512.301	Float Lever	1	303	4512.338	Upper Base	1
102B	4512.302	Float	1	304	4512.339	'L' Shape Bulkhead	1
106	4512.303	Control Panel	1	305	4512.340	Bottom Base	1
107	4512.002	Knob For Humidity Control	1	306	4512.341	Front Plate	1
108	4512.305	Fan Blade	1	307	4512.342	Fan Motor Bracket	1
111	4512.306	Funnel	1	308	4512.343	Spring For Motor	1
112	4512.307	Left Cover For Microswitch	1	309	4512.344	Buckle Of Front Plate	4
113	4512.308	Right Cover For Microswitch	1	311	4512.345	Push Nut	1
114	4512.309	Grommet For Motor	2	312	4512.346	Pad For Float	1
116	4512.311	Filter Frame	1	314	4512.347	Catch For Water Tank	1
121	4512.313	Base For Indicators	2	315	4512.348	Holder For Switch	1
122O	4512.315	Orange Cover Indicator	1	401	4512.349	Cool & Heat Exchangers	1
122R	4512.314	Red Cover Indicator	1	403	4512.350	Suction Tube	1
125	4512.316	Rubber Tube	2	404	4512.352	Discharging Tube	1
126	4512.317	Handle	2	405	4512.353	Tube For Refrigerant Oil	1
127	4512.318	Fixing Socket	4	406	4512.354	Copper Tube	1
128	4512.319	Sensor Holder	2	407	4512.355	Dry Filter	1
201	4512.320	Compressor	1	408	4512.356	Capillary	1
202	4512.321	Fan Motor	1	411	4512.056	Casters	4
203	4512.322	Plug	1	601	4512.360	Screws	2
204	4512.323	Terminal Block	1	701	4512.361	Wind Funnel	1
205	4512.324	Indicator	1	702	4512.362	Wind Funnel	1
207	4512.326	Power Switch	1	703	4512.363	Rubber Foam	1
208A	4512.327	Anti-Frost P.C. Board	1	704	4512.364	Rubber Foam	1
208B	4512.328	P. C. B. Support	4	705	4512.365	Rubber Foam	2
208C	4512.329	Bakelite	1	not shown	4512.351	Thermal Sheath	1
209	4512.031	Switch For Humidity Control	1	not shown	4512.357	Sheath For Capillary	1
210	4512.331	Micro Switch	1	not shown	4512.359	Wires	1
216	4512.335	Strain Relief	1	not shown	4512.310	Evaporator Holder	4
301	4512.336	Main Housing	1				

When ordering parts, be sure to provide the correct model, Desa part number and description.

WWW.SERVISCENTRUM.CZ
 +420 607 607 077
info@serviscentrum.cz