

WWW.SERVISCENTRUM.CZ
+420 607 607 077
info@serviscentrum.cz

Edizione 2012
Rev. A

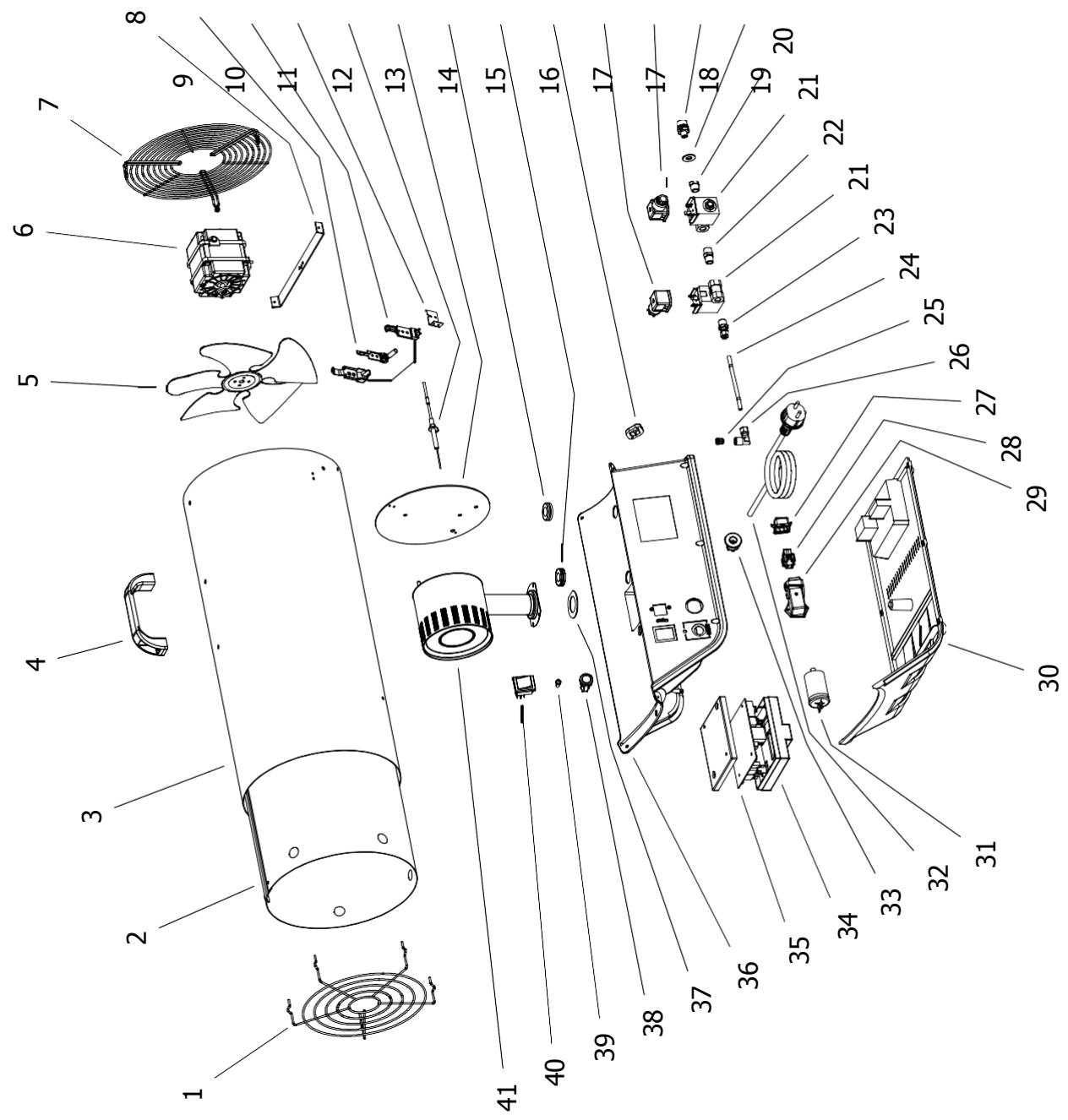

Pos.	Code NR	Description
1	4160.740	OUTLET GRID
2	4162.731	COMBUSTION CHAMBER
3	4162.728	COVER
4	4162.893	PLASTIC HANDLE
5	4160.691	FAN
6	4160.046	MOTOR
7	4160.739	INLET GRID
8	4162.733	MOTOR BRACKET
9	4160.080	AIR PROBE
10	4160.281	COVER AIR PROBE
11	4162.794	AIR PROBE BRACKET
12	4160.237	IGNITION ELECTRICAL FOLDER
13	4162.869	BURNER PLATE
14	4160.646	GROMMET
15	4160.646	GROMMET
16	4161.854	BLOCK FOR NOZZLE
17	4160.020	ELECTROVALVE CABLE
18	4160.048	GAS INLET NOZZLE
19	4160.283	WASHER
20	4160.964	NIPPLES REDUCER
21	4160.963	ELECTROVALVE
22	4161.095	NIPPLES
23	4160.962	REDUCTION NIPPLES
24	4162.724	COPPER TUBE
25	4160.766	GAS NOZZLE
26	4160.967	ELBOW
27	4162.467	CAP FOR THERMOSTAT SOCKET
28	4161.400	CONNEXION SOCKET
29	4160.647	ANGULAR FIX CASE
30	4162.853	LOWER PLASTIC BASE
31	4031.627	CAPACITOR 3 μ F
32	4160.539	POWER CORD
33	4160.635	KEEPER WIRE
34	4160.346	PC BOARD COVER
35	4162.718	ELECTRONIC PC BOARD
36	4162.854	UPPER PLASTIC BASE
37	4160.769	NECK PLATE
38	4160.430	RESET SWITCH
39	4162.790	LED
40	4160.637	SWITCH
41	4160.467	GAS BURNER