

# BV 465

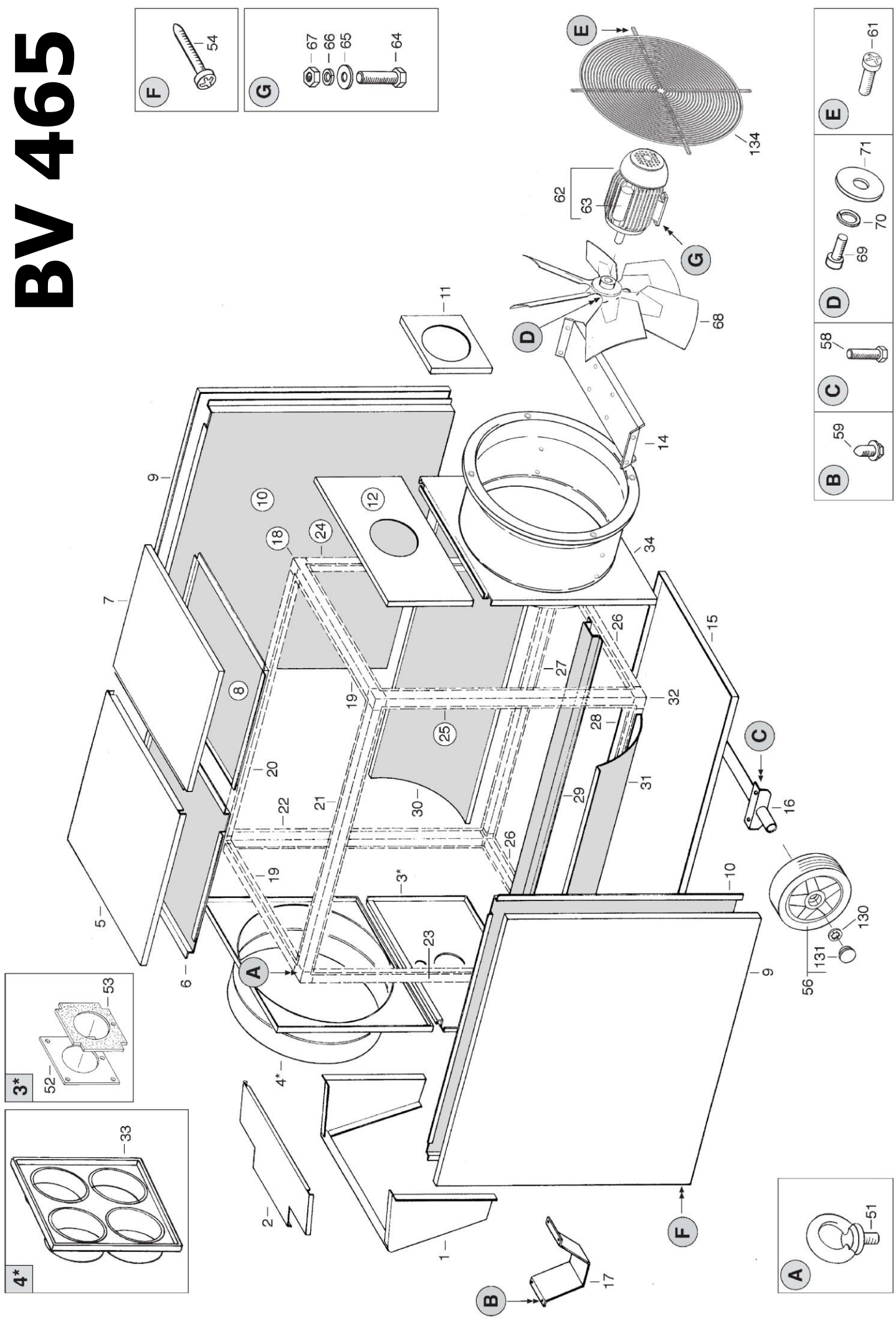

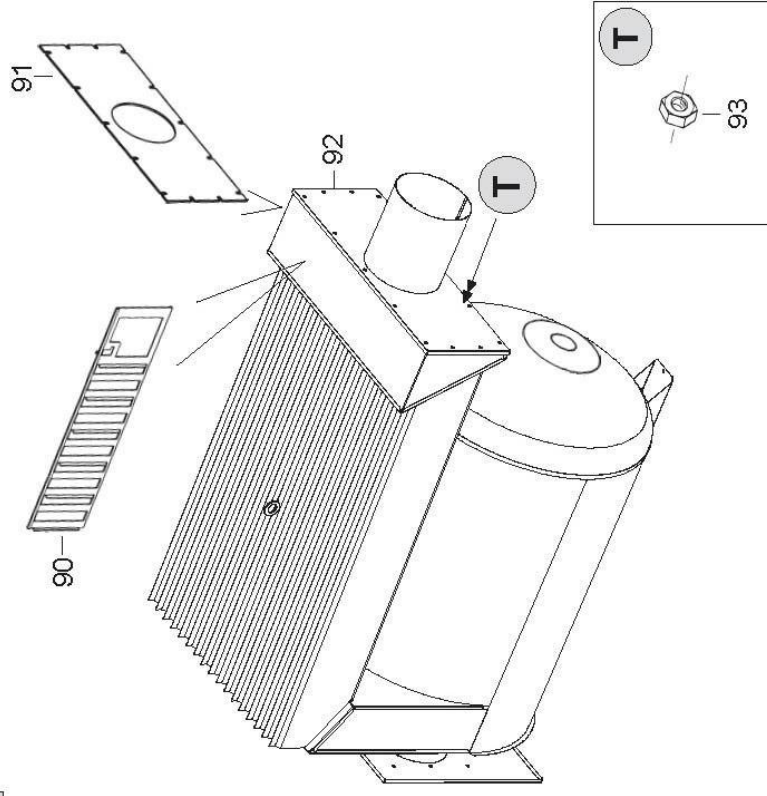
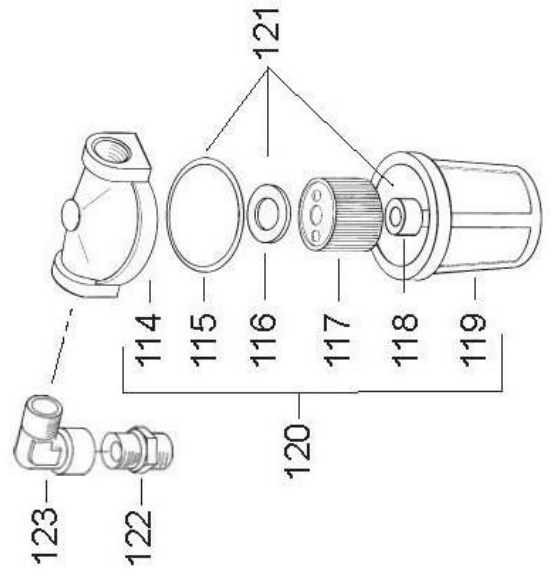
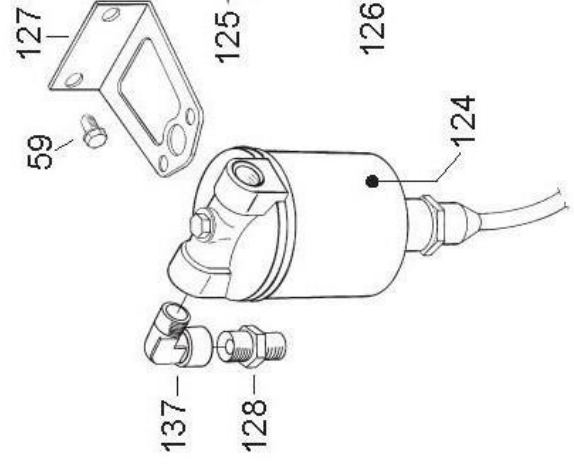
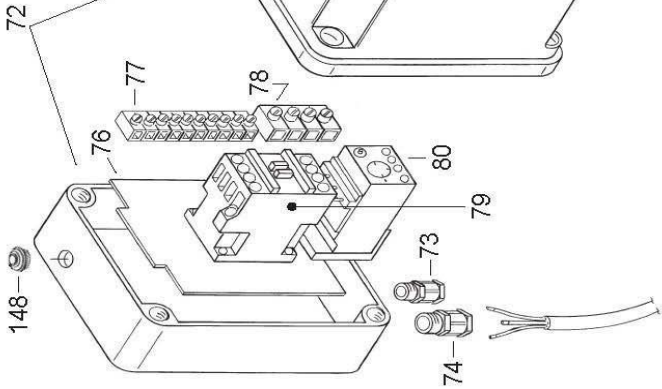

## MASTER HIGH OUTPUT INDIRECT HEATERS BV 465

Pos.	Description	Code
1	Burner Casing	S/R
2	Burner Casing Top Cover	S/R
3	Burner Panel	S/R
4	Outlet Air Panel Ø584	4013.228
5	Front Upper Panel	S/R
6	Inner Panel	S/R
7	Rear Upper Panel	S/R
8	Inner Panel	S/R
9	Side Panel	S/R
10	Inner Panel	S/R
11	Chimney Flange Ø200	4032.221
12	Chimney Panel	S/R
14	Motor Support Plate	4032.016
15	Bottom Panel	4032.222
16	Wheels Axle	4031.344
17	Front Support	4031.183
18	Aluminum Joint With Nut M10	4031.331
19	Upper Short Angle Steel	S/R
20	Upper Long Sx Angle Steel	S/R
21	Upper Long Dx Angle Steel	S/R
22	Vertical Front Sx Angle Steel	S/R
23	Vertical Front Dx Angle Steel	S/R
24	Vertical Back Sx Angle Steel	S/R
25	Vertical Back Dx Angle Steel	S/R
26	Lower Short Angle Steel	S/R
27	Lower Long Sx Angle Steel	S/R
28	Lower Long Dx Angle Steel	S/R
29	Comb. Chamber Support	S/R
30	Comb. Chamber Sx Support	S/R
31	Comb. Chamber Dx Support	S/R
32	Aluminum Joint	4032.161
33	4 Ways Ø275 Panel	4013.227
34	Fan Support Panel	S/R
51	Suspending Ring Screw M10	4031.332
52	Burner Support (Minor 20-Blu 170)	4032.028
53	Burner Plate Seal 210X210X5	4031.201
54	Screw Tc 8X1"	4140.675
56	Wheel Ø250	4031.386
58	Screw Te M8X25	4032.089
59	Screw Te14X1/2" Fr	4032.040
61	Screw Tc M6X16 F.R.	4032.107
62	Motor Hp 1,5 V.230/50 1Ph	4031.345
63	Condenser Mf 32	4031.346
64	Screw Te M8X30	4032.047
65	Washer Ø8XØ24X2,5	4140.668
66	Spring Washer Ø8	4140.669
67	Nut M8	4140.671
68	Fan Ø560	4031.347
69	Screw Te M10X20	4032.169
70	Spring Washer Ø10	4032.043
71	Washer Ø11XØ35X2	4032.046
72	El. Components Box	4031.355
73	Cable Fastener Pg 9	4032.053

## MASTER HIGH OUTPUT INDIRECT HEATERS BV 465

Pos.	Description	Code
74	Cable Fastener Pg 11	4032.052
76	El. Components Support Plate	4032.054
77	Terminal Board 12 El. Mmq 6	4032.055
78	Terminal Board 12 El. Mmq 10	4032.056
79	Contactor Wimex Kn16 V220	4031.334
80	Relay Iskra Trb14 A. 6-10	4032.061
81	Control Knob 1-0-2	4031.268
82	Fuse Holder	4031.902
83	Fuse (5X20) A. 6	4031.102
84	Red Pilot Lamp Ø12 V230	4031.169
89	Combustion Chamber	4032.069
90	Baffle Plate	4032.070
91	Chimney Seal 513X248X5	4032.072
92	Chimney Cover	4032.074
93	Nut M6 Ot	4032.075
94	Female Plug 1"	4032.076
114	Filter Head 1/4"	4032.077
115	Filter Or	4031.150
116	Upper Seal	4031.075
117	Filter Cartridge	4031.015
118	Lower Seal	4031.191
119	Filter Housing	4031.180
120	Filter 1/4"	4031.071
121	Or Kit Filter	4111.116
122	Nipple 1/4"	4031.302
123	Connection 1/4"	4031.302
124	Oil Pre-Heater	4031.120
125	Seal Kit For Oil Pre-Heater	4031.181
126	Filter Cartridge	4031.179
127	Filter Support	4031.122
128	Nipple 3/8"- 1/4"	4032.104
130	Wheel Holder Ø25	4031.177
131	Plastic Plug	4031.178
134	Inlet Grille	S/R
137	Connection 3/8"	4031.581
138	Socket	4111.119
139	Screw Tc 4X1/2"	4032.109
140	Plug	4111.118
141	El. Components Box	4031.582
142	Bulbs Holder	4032.120
143	Clip	4032.121
144	Thermostat Ty95 30/90 °C	4032.122
145	Thermostat Ty95H 120 °C	4032.123
146	Thermostat Ty95 0/60 °C	4032.124
147	Safety Thermostat Plastic Profile	4032.125
148	Cable Protection Ø18	4162.101
not shown	Room Thermostat Th 5	4150.105
not shown	Air Hose Ø305 Mm, 7,6 M For 4-Way Outlet	4031.406
not shown	Fuel Pipe Flex 4 M	4031.460

S/R = Parts available by special request only