

Galaxy 29C

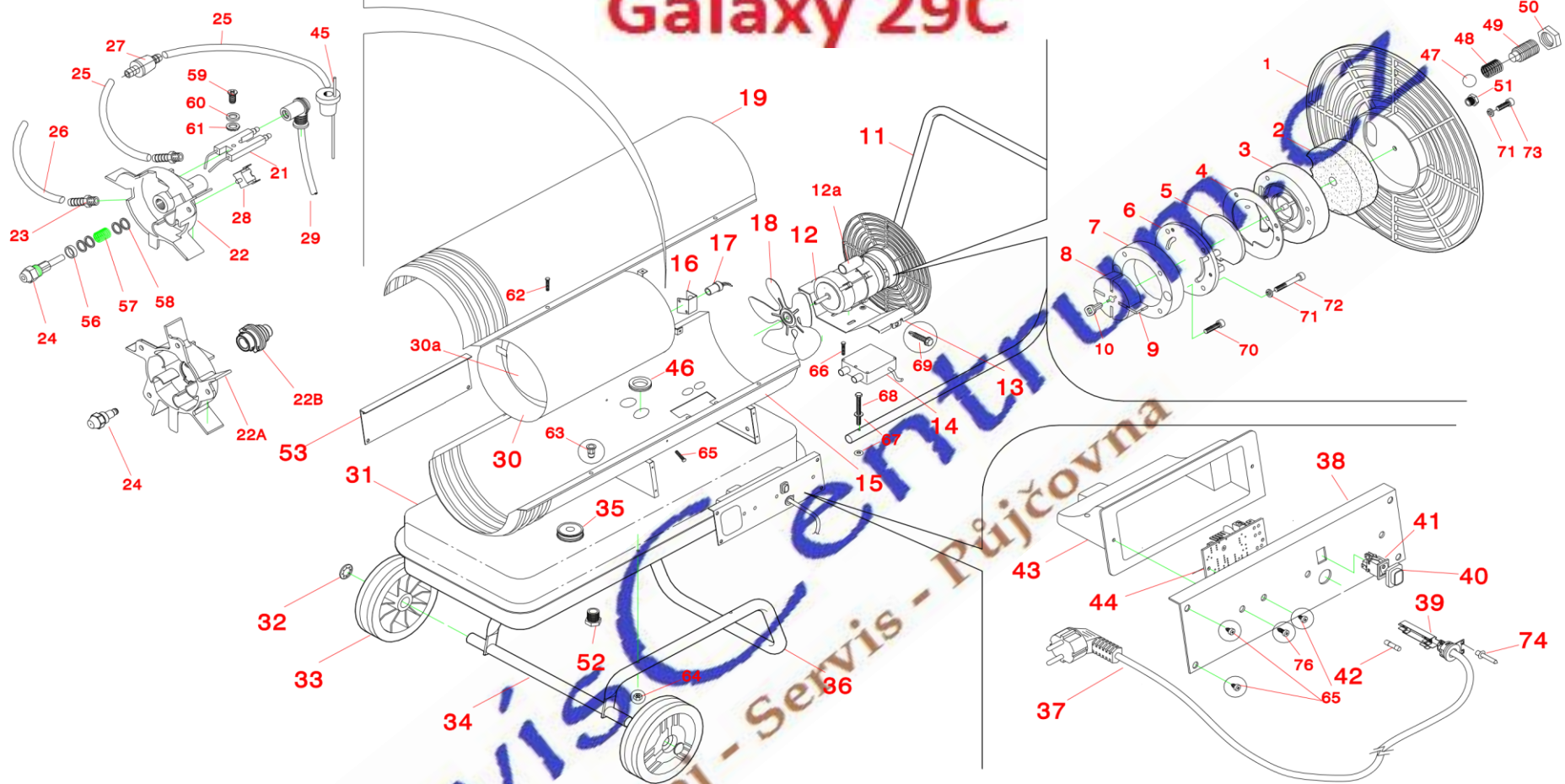

SPARE PART LIST

GRY 28 WD



PICT. POS.	OLD PART NR	NEW PART NR	DESCRIZIONE	DESCRIPTION	DA/FROM FINO A/TO	NOTE / NOTES
	1 1006000211	20010092	GRIGLIA POSTERIORE	REAR GRID		D. 210mm
1	2 1086001711	20190009	FILTRO ASPIRAZIONE	SUCTION FILTER		
	1 1094007311	20620056	COPERCHIO FILTRO	FILTER CASING		
1	4 1002001311	20020003	GUARNIZIONE	GASKET		
1	5 1086000111	20190000	FILTRO MANDATA	OUTLET FILTER		
	1 1094007211	20620055	COPERCHIO COMPRESSORE	COMPRESSOR COVER		
1	7 1094008111	20620060	ANELLO STATORE	STATOR RING	giu-07	Sp. 17.01mm sost. 1099002811
1	8 1099001611	20260018	ROTORE	ROTOR		Sp. 17mm
1	9 1099001511	20260017	PALETTA	BLADE		Sp. 17mm
	1 1001008211	20010015	GIUNTO	COUPLING		L=15mm
	1 MANT#GRY2820	20610185	MANIGLIA	HANDLE		NERA RAL 9005
1	12 1040005511	20400015	MOTORE	MOTOR		150W 230V 50Hz
1	12A 1049001000	20490008	CONDENSATORE	CAPACITOR		6,3µF
	1 1094006011	20620047	SUPPORTO MOTORE	MOTOR SUPPORT		
1	14 1033004111	20330010	TRASFORMATORE	TRANSFORMER	giu-06	sost. 1033001211-1033003611- 1033004700 fornire n°2 cavi 1039041311
	1 1094080511	20630080	CORPO INFERIORE	LOWER BODY	giu-06	RED RAL 3000 - SPECIFY RAL IF DIFFERENT
	1 CRPGRYP#028STD11	20631115	CORPO INFERIORE	LOWER BODY	giu-06	RED RAL 3000 - SPECIFY RAL IF DIFFERENT
	1 1094013111	20620090	STAFFA FOTOCELLULA	FLAME SENSOR SUPPORT		ott-03
	1 1094104211	20620529	STAFFA FOTOCELLULA	FLAME SENSOR SUPPORT	ott-03	
1	17 1050000311	20500001	FOTOCELLULA	FLAME SENSOR		ott-03
1	17 1050000911	20500003	FOTOCELLULA	FLAME SENSOR	giu-05	sost. 1050000711
1	18 1087003511	20200023	VENTOLA	FAN		D. 210mm 34°

DATE: 03.03.08

REV. 00

REV. DATE 03.03.08

List 1

SPARE PART LIST

GRY 28 WD



1	19	COPERGRYP#028STD91120630704	CORPO SUPERIORE	UPPER BODY	giu-06	RED RAL 3000 - SPECIFY RAL IF DIFFERENT	
1	19	COPGRYP#028STD11	20630863	CORPO SUPERIORE	UPPER BODY	giu-06	RED RAL 3000 - SPECIFY RAL IF DIFFERENT
1	21	1030001111	20300006	ELETTRODO ACCENSIONE	IGNITION ELECTRODE		
1	22	1094007111	#N/A	TESTA COMBUSTIONE	BURNER HEAD	giu-04	
1	22A	1094138011	20620672	TESTA COMBUSTIONE	BURNER HEAD	giu-04	
1	22B	1001017011	20010059	PORTAUGELLO	NOZZLE HOLDER	giu-04	
1	23	1067006011	20120036	PORTAGOMMA	HOSE CONNECTOR	giu-04	1/8"Mcon. D.8mm
1	24	1088005711	20210035	UGELLO	NOZZLE	giu-04	SNA 0.75 GPH
1	24	1088014311	20210063	UGELLO	NOZZLE	giu-04	SNA 0.75 GPH
1	25	1078001611	20160030	TUBO GASOLIO	OIL HOSE		L=200mm
1	26	1078000311	20160021	TUBO ARIA	AIR HOSE		L=480mm
PICT. POS.	OLD PART NR	NEW PART NR	DESCRIZIONE	DESCRIPTION	DA/FROM A/TO	FINO	NOTE / NOTES
1	27	1086001911	20190010	FILTRO ASPIRAZIONE	OIL SUCTION FILTER		
1	28	1036001611	20360006	TERMOSTATO SICUREZZA	SAFETY THERMOSTAT		
1	29	1039041311	20390281	CAVO AT	HT CABLE	giu-06	L=500 + PIPETTA 90° c/filtro 1Kohm sost. 1039005511 - 1039033211 - 1039033311 - 1039043500
1	30	CAMERA#GRY328	20621496	CAMERA COMBUSTIONE	COMBUSTION CHAMBER		
1	30A	1094051511	20620251	DISCO PARAFIAMMA	FLAME SHIELD		
1	31	SRBGRY#028STD070302020631789	SERBATOIO	TANK	giu-07		30 Lt. NERO RAL 9005 sost. SERBGRYP#028STD20 - fornire tappo cod. 1005002711 / supply cap part nr 1005002711
1	32	1022000911	20230222	ANELLO FISSAGGIO RUOTA	WHEEL RING		D. 20mm
1	33	1004000311	20040002	RUOTA	WHEEL		D. 175mm
1	34	ASSALE#GRY2820	20610142	ASSALE	AXLE		NERO RAL 9005 L=485mm

DATE: 03.03.08

REV. 00

REV. DATE 03.03.08

List 1

SPARE PART LIST

GRY 28 WD



1	35	1005002711	20050018	TAPPO SERBATOIO	TANK CAP	giu-07	D. 76mm NERO ERMETICO
1	35	1094004311	20620034	TAPPO SERBATOIO	TANK CAP	giu-07	D. 55mm
1	36	TELAOT#GRY02820	20610215	TELAIO	FRAME		NERO RAL 9005
1	37	CAVAL#EUR1500EURP2	20390357	CAVO ALIMENTAZIONE	POWER CORD		H07RNF 3x1 L=1500mm + EU SCHUKO PLUG
1	37	CAVAL#EUR1500UKSP2	20390363	CAVO ALIMENTAZIONE	POWER CORD		H07RNF 3x1 L=1500mm + UK PLUG
1	37	CAVAL#EUR1500SUIP2	20390361	CAVO ALIMENTAZIONE	POWER CORD		H07RNF 3x1 L=1500mm + SUI PLUG
1	38	CRUSCGRYP#028F20	20631180	CRUSCOTTO FOR.	LEFT SIDE PANEL	giu-02	NERO
1	38	CRUSCGRYP#028N20	20621803	CRUSCOTTO FOR.	LEFT SIDE PANEL	giu-02	NERO
1	39	1031001800	20310010	PASSACAVO	CABLE CLAMP		
1	41	1032001900	20320005	INTERRUTTORE	SWITCH		
1	42	1035001111	20350006	FUSIBILE	FUSE		3.15A
1	43	1001007736	20010012	PROTEZIONE QUADRO	ELECTRICAL PANEL COVER		
1	44	1047000811	20470004	CONTROLLO FIAMMA	CONTROL UNIT	giu-02	
1	44	1047003611	20470013	CONTROLLO FIAMMA	CONTROL UNIT	giu-02	230V 50Hz
1	45	1002005711	20020019	GOMMINO PESCANTE	SUCTION GASKET		
1	46	1002002100	20020007	GOMMINO	RUBBER RING		
	47	1023002411	20230229	SFERA	BALL		D. 6mm IN C40
1	48	1023004511	20230234	MOLLA	SPRING		
1	49	1023002511	20230230	VITE REGOLAZIONE	ADJUSTING SCREW		GRANO M8x1 L=20mm
1	50	1017002111	20230124	DADO	NUT		M8x1 ZN UNI 5589 8
1	51	1067006911	20120039	TAPPO	CAP		T.E. 1/8Mcil.
1	52	1067007000	20120040	TAPPO SCARICO	DRAIN CAP		T.E. 3/8Mcil.
PICT. POS.		OLD PART NR	NEW PART NR	DESCRIZIONE	DESCRIPTION	DA/FROM FINO A/TO	NOTE / NOTES
1	53	CRUSCGRYP#028C20	20621800	CRUSCOTTO CIECO	SIDE PANEL		NERO
1	56	1002001111	20020001	GOMMINO UGELLO	NOZZLE RUBBER RING	giu-04	
1	57	1023004111	20230232	MOLLA UGELLO	NOZZLE SPRING	giu-04	
1	58	1018001311	20230145	RONDELLA	WASHER	giu-04	D. 6.5X10 ZN UNI 6593
1	59	1016006000	20230044	VITE	SCREW		T.C.C. M4x16 ZN ISO 7045 4.8

DATE: 0.

REV. 00

REV. DATE 0

List 1

SPARE PART LIST

GRY 28 WD



1	60	1018001000	20230143	RONDELLA	WASHER	M4 ZN UNI 8842-A
1	61	1018001000	20230143	RONDELLA	WASHER	M4 ZN UNI 8842-A
1	62	1016005211	20230037	VITE	SCREW	T.C.C. M5x10 ZN ISO 7045 4.8
1	63	1019001600	20230184	RIVETTO	RIVET	M5
	64	1017000600	20230113	DADO	NUT	M5 ZN UNI 5588 8
1	65	1016001600	20230012	VITE	SCREW	T.C.C. D. 3.9x6.5
1	66	1016005711	20230042	VITE	SCREW	T.C.C. D. 4.8x38 ZN ISO 7049
1	67	1018000800	20230142	RONDELLA	WASHER	x M5 ZN ISO 7089
1	68	1016000100	20230000	VITE	SCREW	T.E. M5x50 ZN ISO 4017 8.8
1	69	1016010200	20230075	VITE	SCREW	sost. 1016004500 - AUTOPERF.T.E. D. 4.8x16
1	70	1016005011	20230035	VITE	SCREW	T.C.E.I. M5x20 ZN DIN 7984 8.8
1	71	1018001600	20230148	RONDELLA	WASHER	GROWER x M5 DIN 127
1	72	1016005100	20230036	VITE	SCREW	T.C.E.I. M5x35 ZN ISO 4762 8.8
1	73	1016007700	20230058	VITE	SCREW	T.C.E.I. M5x16 ZN ISO 4762 8.8
1	74	1019002800	20230194	RIVETTO	RIVET	D. 4.0x9.5
1	76	1016001700	20230013	VITE	SCREW	AUTOFIL. T.C.C. D. 3.9x9.5 ZN ISO 7049
		1105010600	20290023	ADESIVO TENSIONE	VOLTAGE LABEL	
		1105142100	20290982	ADESIVO AVVERTENZE	WARNING LABEL	giu-06
		1106003111	20380015	LIBRETTO ISTRUZIONI	INSTRUCTION MANUAL	
		GRCOMPGRYP#028EST 20621848		GRUPPO COMPRESSORE	COMPRESSOR ASSY	
		SCATACCGRYP#028	20840137	SCATOLA ACCESSORI	ACCESSORIES SET	
		1101011411	20270044	FONDO SCATOLA	CARTON BOX BASE	
		1101011711	20270047	COPERCHIO SCATOLA	POLYSTYRENE INSERT	
		1101012211	20270051	INSERTO POLISTIROLO	CARTON BOX COVER	

DATE: 03.03.08

REV. 00

REV. DATE 03.03.08

List 1